



CAPABILITY STATEMENT



Delivering
the Best...
Every Time.



First established in 2005, we have grown to become a provider of choice for leading national and multinational clients.

With operations across Australia and Papua New Guinea, FMS Group provides a wide range of services across all industries, specialising in the maintenance of client assets to reduce downtime and increase efficiency. We pride ourselves on being the complete offering for service delivery and capital equipment sales, providing end-to-end solutions for your site and assets.

Our diverse team are experienced in diesel and mobile plant, fixed plant, projects, workshop and fabrication, machining, electrical and engineering services. As a multi-faceted business offering end-to-end solutions for our clients, we are known as a 'one-stop-shop' and continue our proud heritage of responsiveness, consistency and efficiency.

Operations



Head Office - Mackay

Mackay serves as the central hub for several critical functions within FMS Group. It hosts the Head Office, providing shared services across the entire group, including asset and logistics management. The Mackay site supports on-site operations and associated services across Queensland, and it is home to our Queensland workshops and machining division. Additionally, it houses spare parts for FMS Group products and equipment associated with the East Coast.

Western Australia - Henderson

Henderson serves as the Head Office for supporting customers across the Western Australia region. This site offers on-site services and operates a workshop building FMS products, along with our respected partner products including Ground Force and TowHaul equipment. It also specialises in mobile equipment repairs, fabrication of engineered solutions and stocks spare parts for our full offering of products in the West.

Brisbane

The Brisbane facility specialises in manufacturing of FMS Group products and equipment, covering areas including New South Wales, Queensland, Victoria, Northern Territory and Papua New Guinea. This location also handles specialist engineering projects and overhauls for Northern New South Wales, the Hunter Valley, Southeast Queensland, and supports overflow work for the Bowen Basin/CQ workshops. Spare parts for all FMS Group products and equipment are also stocked here.

Subiaco Corporate Office

Located in Perth's CBD, the Subiaco office focuses on sales support for FMS Group's full range of services and equipment.

Port Moresby

While our primary coordination hub is supported out of Head Office Mackay, FMS Group Papua New Guinea maintains a robust in-country presence to support administration functions and compliance with local Papua New Guinea regulations.



Pillars

At FMS Group, our business is built around three core pillars – Service, Projects and Equipment – which create a comprehensive offering for our clients across various industries. Our full suite of services and expertise has been built from a small team in 2005, to now 600+ employees who together provide tailored solutions and maintenance on mobile plant, diesel and fixed plant equipment. Our Projects pillar takes these services and combines them with in-house project management, engineering and execution teams to provide a one-stop multi-faceted service to our customers. Our new Equipment divisions delivers a wide range of synergistic capital and ancillary equipment, along with critical spares to ensure operational uptime.

Service



Mobile Plant / Diesel
Draglines & Rope Shovels
Fixed Plant
Electrical
Machining
Workshops
Heavy Lifts (SLS)

Projects



EPC/M (Engineering,
Procurement, Construction &
Management)
Major Shutdowns
System Upgrades
Engineering

Equipment



Capital Equipment
Ancillary Equipment
Spares

Company Values: 'Our Choices'

FMS Group is built on a strong team culture, prioritising safety, work/life balance and employee commitment. Our company values, known as 'Our Choices,' guide every aspect of our operations:

**F****First in safety**

We choose to be safe in everything we do.

**M****Mates in the Workplace**

Everything we do, we do together. We always look out for each other.

**S****Supporting work/life balance**

We put our best foot forward at work, to enjoy our family, friends and the community in which we live and support.

**G****Group Success**

Built on employee commitment. We take ownership of our work and quality and strive for excellence.



"Our People are Our Community."

Services

FMS Group is your one-stop shop for the supply of good quality equipment, components, parts and comprehensive maintenance services to meet your business needs. We also deliver end-to-end project and shutdown solutions that set us apart as the provider of choice for leading national and multinational clients across industries such as mining, construction, oil and gas, marine and renewables.

We cover Australia and Papua New Guinea with 24-hour breakdown maintenance support, dragline, electric shovel and excavator expertise, fixed plant and machinery overhauls including project planning and management. Our specialised equipment and highly skilled people deliver the best outcome for our clients, every time.

Our extensive services across Australia include:

Diesel / Mobile Plant

Our highly skilled tradespeople provide maintenance and breakdown support to sites across Australia and PNG, with our team ensuring the continued operation of your heavy machinery and equipment with expertise in diesel mechanics. Covering mobile equipment outages, machine relocations and demobilisations with experience in the most complex shutdowns.

Field / Fixed Plant

Our onsite/adhoc skilled labour delivers mechanical and structural maintenance services in the mineral processing and resource sectors. Our team has extensive experience in fixed plant, wash plant and prep plant shutdowns, along with field equipment outages.

Workshop

Providing fully equipped fabrication workshops in Queensland and Western Australia, we offer:

- Heavy gauge plate pressing and bending
- CNC plasma cutting
- Ferrous and non-ferrous welding and fabrication
- Coded welders
- In-house ticketed international weld supervisors
- Weld procedure construction and testing
- Engineering design and drafting support
- Mobile equipment overhauls and repair
- On site scope development



Electrical

Our skilled electrical division provides qualified tradespeople and supervisors to contribute to achieving minimal machinery downtime and maintenance costs no matter the industry. Our electrical team have extensive experience in:

- Field maintenance
- High voltage switching
- Fixed plant and infrastructure maintenance
- CHPP's
- Service days
- Shutdowns
- Electric drive trucks
- Electrical projects (power stations, substations, renewables etc.)

Onsite Machining

Our onsite machining services minimise downtime during your project, offering capabilities such as XY milling, radial/circular milling and line boring. The machining team operate both on site as well as in our workshop facility's.

Engineering

Our in-house engineering team conduct heavy lift planning, equipment jacking studies and design innovative tooling products to provide safer and more efficient solutions for our clients. FMS Group's experienced engineers support all divisions of the company to deliver superior outcomes no matter the challenge.

Safety Lift Solutions (SLS)

Recognising the need for integrated shutdown solutions, our Safety Lift Solutions (SLS) team offer cutting-edge lifting solutions that leverage the latest hydraulic lifting technology supported by our in-house engineering team. This jacking technology and equipment (1200t and 1600t sets of jacks) are supported by FMS Group DHPU/ Motivators and hydraulic skid systems which make light work of attachment and hydraulic component changeouts, removing the need for intermittent operations and making operations safer, faster and more reliable.



Projects

At FMS Group we specialise in end-to-end project and shutdown maintenance solutions. Growing significantly over the years and combining the capabilities of multiple streams of specialist trades as well as technicians, engineers and project managers from across the group, we work collaboratively to produce the best results.

With design, construction, remediation and asset-maintenance services, our team will extend the life of your assets and equipment, reducing downtime and delivering the best outcome for your specific project needs. Our ability to provide turnkey project solutions makes us a reliable principal contractor for major works.

We offer a mobilisation-ready workforce and in-house engineering team to provide specialist design, engineering, installation and maintenance services on structural, mechanical, electrical, fixed plant and mobile assets.

Our Projects Division incorporates a variety of offerings:

- Full EPC/M turnkey infrastructure solutions
- Power stations, renewables, HV substations, transmission and distribution cables and powerlines, MV/LV systems (switchboards, cables and MCCs), control systems and communication systems.
- Maintenance, installation and commissioning
- Design, construction and scheduled maintenance shutdowns
- Dragline, shovel, excavator and fixed plant expertise
- Concrete remediation and structural steel repairs
- Full fleet of mine spec light vehicles and boilermaker trucks
- Shutdown containers, specialised tooling and equipment
- In-house engineering team
- Fabrication Workshop
- Safety Lift Solutions jacking technicians and equipment
- Machine relocations, assemblies, disassemblies and demobilisations
- On or offsite machinery overhauls

Our one-stop-shop approach and vast range of in-house support services allows us to exceed customer expectations on every project. We have the technical knowledge, experienced project managers and diverse equipment offering to deliver reliable, cost-effective and quality service and results.

We Deliver the Best... Every Time.



Mining



Renewables



Industrial



Construction



Marine



Equipment

FMS Group Equipment Division completes the mining maintenance and service cycle by providing our clients with the supply and support of a range of equipment that improves site operational productivity through reducing plant and machinery downtime and operational interruptions, while improving safety and maintenance efficiency.

Additionally, for all our products, FMS Group holds the critical spares and provides onsite after-sales support through our in-house engineering and technical teams.

Our Trusted Brands & Partnerships



FMS Group is the official distributor, manufacturer and servicing agent of Ground Force products across Australia.

Ground Force Worldwide offers reliable and quality solutions for surface mining applications and heavy-duty construction, from fuel delivery and water distribution to cable handling, road maintenance and custom hauling.

As the official distributor and servicing agent, FMS Group ensures you receive the best products and top-notch support.



FMS Group offers TowHaul's incredible range of lowboy trailers and haul truck towing equipment. TowHaul equipment is perfect for moving tracked and wheeled machines like dozers, shovels, graders and excavators, speeding up return to operations and reducing costs.

From surface mining to heavy-duty construction, we have the equipment to meet your needs.



Our Trusted Brands & Partnerships



FMS Group introduced a new product line to market across the Oceania and wider regions in 2024, branded HAWC - Hard As Wear Components. This product is made up of many different subcategories including undercarriage that suits most brands of hydraulic and electric excavators and shovels. Other categories include mill and liner packages for fixed plant, along with lips and edges for excavators and shovels.

We are proud to provide the best material specification, heat treatment technology and design characteristics both internal and external, to engineer this range of products.



FMS Group design, engineer and manufacture a range of specialised tooling equipment to make work safer, easier and more efficient. Feature products include our Load Roller Stands and Hydraulic Power Pack.

- The FMS Load Roller Stands allow for the quick and easy change-out of load rollers, designed to be used on either one track frame or both, reducing machine downtime compared to other methods.
- The FMS Hydraulic Power Pack allows the user to operate excavator and shovel attachment remotely, reducing risk to personnel.

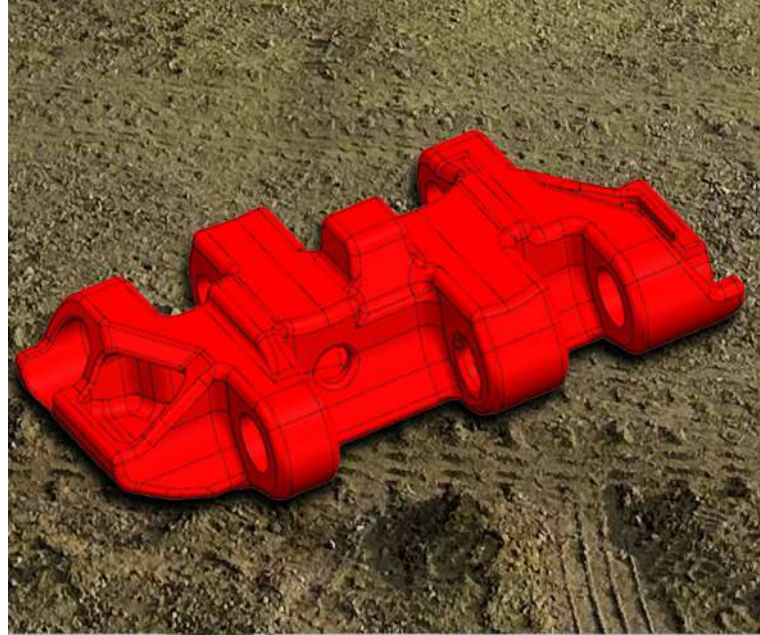



Health and Safety

At FMS Group, we are committed to contributing to a sustainable future through responsible business practices that provide employees with a safe and inclusive workplace, create value for the communities in which we operate and respect the environment. We achieve this objective through active engagement in innovation, adherence to progressive industry best practices and compliance with government direction and legislation.

FMS acknowledges its moral and legal obligation to always operate in a safe manner and is dedicated to protecting the safety of our workforce. Our commitment to health, safety and the wellbeing of our people and communities is demonstrated through strong safety leadership, active engagement with our workforce and stakeholders and a constant focus on identifying and managing risks. We recognise the challenges in maintaining and improving our performance and continuously engage with our people to safeguard against complacency in the workforce.

The entire group follows the standards and protocols of our Central Queensland operations to ensure quality and safety standards are met, regardless of certification status or location.

QLD operations – CQFMS certified to:



Quality Assurances

In Queensland our business operates under an Integrated Management System (HSEQ) aligned with international standards. Our Central Queensland operations maintain certification to ISO9001:2015 Quality Management System, the ISO14001:2015 Environmental Management System and the ISO45001:2018 Safety Management System. We utilise this Integrated Management System to ensure we meet our commitments to sustainability, safety and quality.





Community Support and ESG Initiatives

Our ESG efforts extend beyond sponsorships. FMS Group actively engages in and supports initiatives that promote environmental sustainability, social responsibility and good governance. FMS Group is dedicated to ensuring we maintain the highest standards of corporate governance and actively engage in projects and initiatives that will reduce our environmental footprint.

Making a Positive Impact in Our Communities

FMS Group is committed to giving back to the communities in which we operate. We sponsor numerous community groups, organisations and sporting clubs across the country, with our sponsorships guided by employee feedback and their alignment with our company values. Since 2005, FMS Group has donated significant resources to causes that resonate with our team and have a meaningful impact on local communities.

Environmental, Social and Governance (ESG) Commitment

We are dedicated to reducing our environmental footprint, enhancing the wellbeing of our workforce and the communities we serve, and maintaining the highest standards of corporate governance. Our Mackay Headquarters boasts a 300kw solar carport, complemented by a 250kwh battery storage system to enhance energy resilience and grid independence, contributing to our goal of achieving 50% renewables by 2030.

“FMS Group donates well over \$200,000 each year to support community initiatives and organisations, helping our people thrive”



FMS Group Capability Statement



FMS

G R O U P



(07) 4952 6557



enquiries@fms-group.com.au
sales@fms-group.com.au



fms-group.com.au



Head Office
40 Production Drive
Paget QLD 4740

